



1	Korytarz	6,03 m ²
2	Łazienka	4,83 m ²
3	Pokój	13,53 m ²
4	Salon z aneksem kuch.	22,76 m ²

SUMA 47,15 m²

Loggia 6,11 m²

 ściany do zachowania
 ściany działowe możliwe do wyburzenia

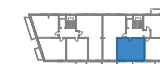

ul. Stanisława Worcella

