

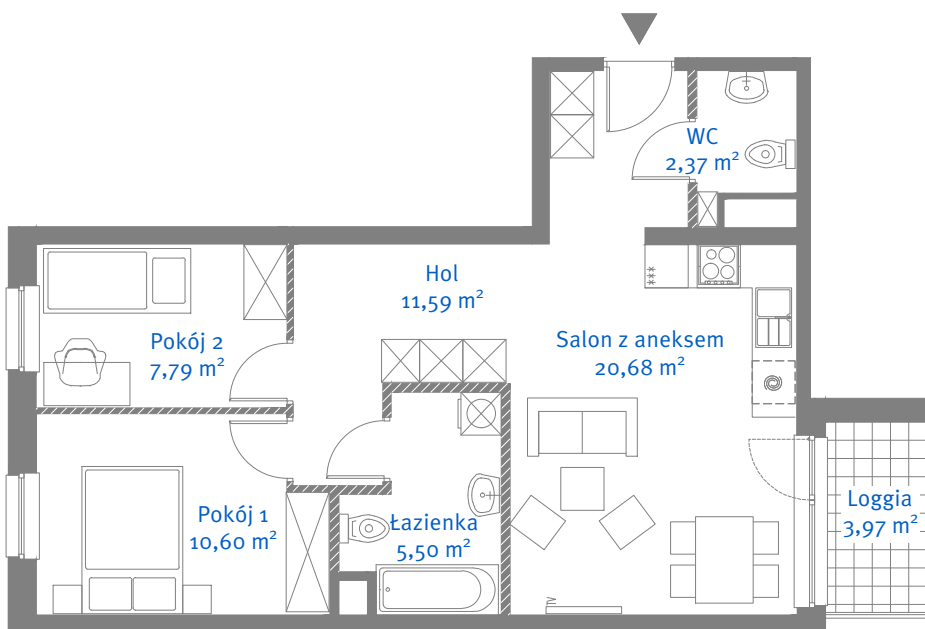

1	Salon z aneksem	20,68 m <sup>2</sup>
2	Hol	11,59 m <sup>2</sup>
3	Pokój 1	10,60 m <sup>2</sup>
4	Pokój 2	7,79 m <sup>2</sup>
5	Łazienka	5,50 m <sup>2</sup>
6	WC	2,37 m <sup>2</sup>

**SUMA 58,53 m<sup>2</sup>**

Loggia 3,97 m<sup>2</sup>



 ściany do zachowania  
 ściany działowe możliwe do wyburzenia

